

BOROUGH OF MATAWAN

MONMOUTH COUNTY, NEW JERSEY

ROAD MAP ZONING MAP

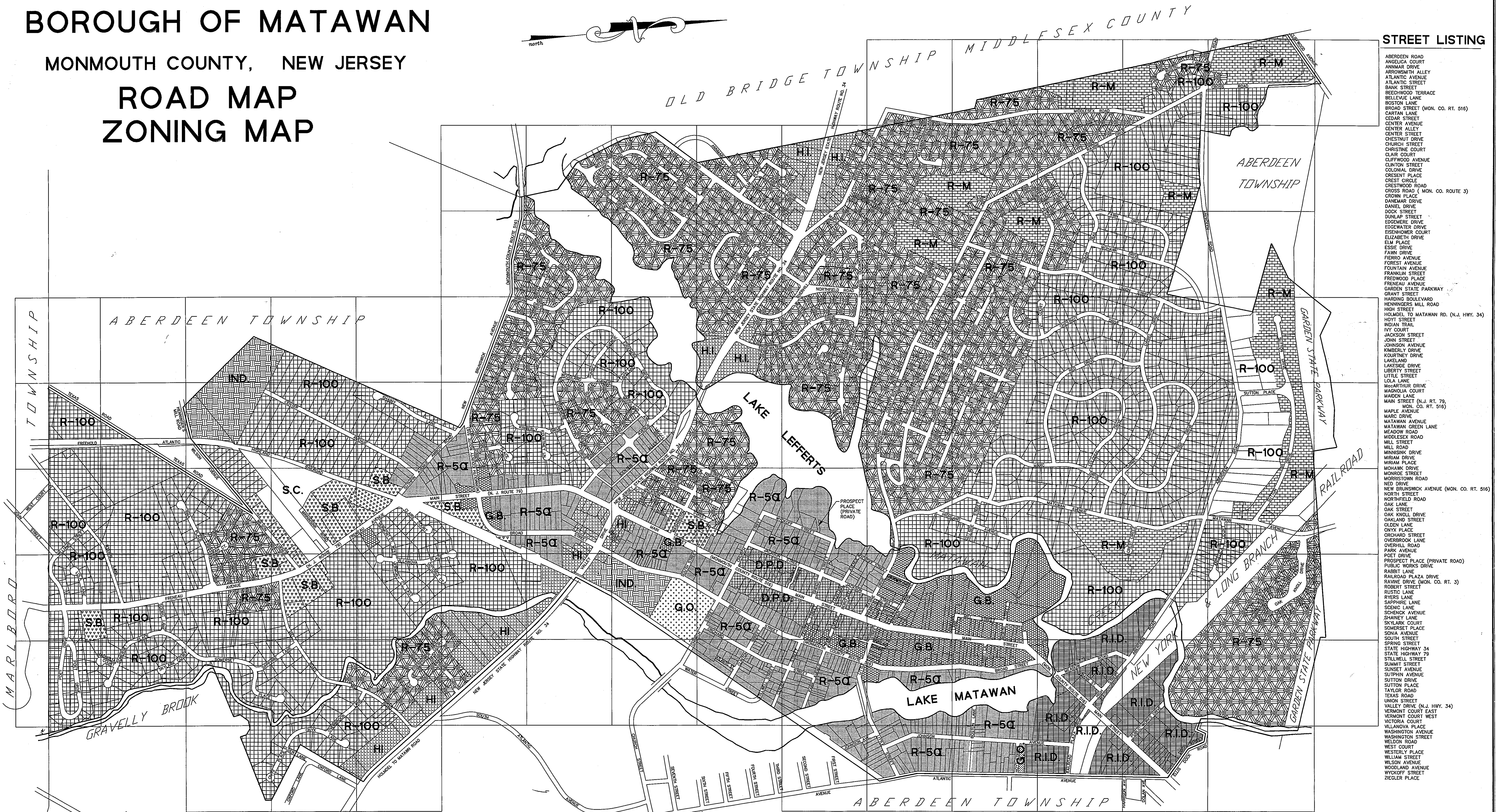
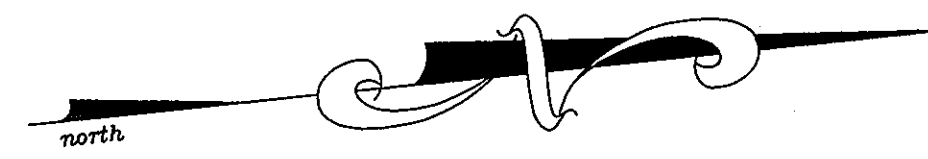

STREET LISTING

- ABERDEEN ROAD
- ANGELIA COURT
- ANNMAR DRIVE
- ARROWSMITH ALLEY
- ATLANTIC AVENUE
- ATLANTIC STREET
- BANK STREET
- BEECHWOOD TERRACE
- BELLEVUE LANE
- BOSTON LANE
- BROAD STREET (MON. CO. RT. 516)
- CARTAN LANE
- CEDAR STREET
- CENTER AVENUE
- CENTER ALLEY
- CENTER STREET
- CHESTNUT DRIVE
- CHURCH STREET
- CHRISTINE COURT
- CLAIR COURT
- CLIFFWOOD AVENUE
- CLINTON STREET
- COLONIAL DRIVE
- CRESENT PLACE
- CREST CIRCLE
- CRESTWOOD ROAD
- CROSS ROAD (MON. CO. ROUTE 3)
- CROWN PLACE
- DANEMAR DRIVE
- DANIEL DRIVE
- DOCK STREET
- DUNLAP STREET
- EDGEWATER DRIVE
- EDGEWATER DRIVE
- EDSINHOWER COURT
- ELIZABETH DRIVE
- ELM PLACE
- ESSE DRIVE
- FAWN DRIVE
- FERRIS AVENUE
- FOREST AVENUE
- FOUNTAIN AVENUE
- FRANKLIN AVENUE
- FREDWOOD PLACE
- FRENEAU AVENUE
- GARDEN STATE PARKWAY
- GRANT STREET
- HARDING BOULEVARD
- HENNINGERS MILL ROAD
- HIGH STREET
- HOLMDEL TO MATAWAN RD. (N.J. HWY. 34)
- HOYT STREET
- INDIAN TRAIL
- IVY COURT
- JACKSON STREET
- JOHN STREET
- JOHNSON AVENUE
- KIMBERLY DRIVE
- KOURTNEY DRIVE
- LAKELAND DRIVE
- LAKESIDE DRIVE
- LIBERTY STREET
- LITTLE STREET
- LOLA LANE
- MARSHUR DRIVE
- MAGNOLIA COURT
- MARDEN LANE
- MAIN STREET (N.J. RT. 79, MON. CO. RT. 516)
- MAPLE AVENUE
- MARC DRIVE
- MATAWAN AVENUE
- MATAWAN GREEN LANE
- MEADOW ROAD
- MIDDLESEX ROAD
- MILL STREET
- MILL ROAD
- MINNSINK DRIVE
- MIRIAM DRIVE
- MIRIAM PLACE
- MOHAWK DRIVE
- MORRIS TOWN ROAD
- NED DRIVE
- NEW BRUNSWICK AVENUE (MON. CO. RT. 516)
- NORTH STREET
- NORTHFIELD ROAD
- OAK LANE
- OAK STREET
- OAK KNOLL DRIVE
- ORCHARD STREET
- OLDEN LANE
- ONYX PLACE
- ORCHARD STREET
- OVERBROOK LANE
- OVERHILL ROAD
- PARK AVENUE
- POST DRIVE
- PROSPECT PLACE (PRIVATE ROAD)
- PUBLIC WORKS DRIVE
- RABBIT LANE
- RAILROAD PLAZA DRIVE
- RAMME DRIVE (MON. CO. RT. 3)
- ROBERTY STREET
- RUSTIC LANE
- RYERS LANE
- SAPPHIRE LANE
- SCENIC LANE
- SHENCK AVENUE
- SHANEY LANE
- SKYLARK COURT
- SOMERSET PLACE
- SONIA AVENUE
- SOUTH STREET
- SPRING STREET
- STATE HIGHWAY 34
- STATE HIGHWAY 79
- STILLWELL STREET
- SUMMIT STREET
- SUNSET AVENUE
- SUTPHIN AVENUE
- SUTTON DRIVE
- SUTTON PLACE
- TAYLOR ROAD
- TEXAS ROAD
- UNION STREET
- VALLEY DRIVE (N.J. HWY. 34)
- VERMONT COURT EAST
- VERMONT COURT WEST
- VICTORIA COURT
- VILLANOVA PLACE
- WASHINGTON AVENUE
- WASHINGTON STREET
- WELDON ROAD
- WEST COURT
- WESTERLY PLACE
- WILLIAM STREET
- WILSON AVENUE
- WOODLAND AVENUE
- WYCKOFF STREET
- ZIEGLER PLACE

LEGEND

- | | | | | | | | |
|--|-----------------------|--|---------------------------------------|--|---------------------------------------|--|--------------------------------------|
| | G.B. GENERAL BUSINESS | | R-M RESIDENTIAL GARDEN APARTMENTS | | R-100 RESIDENTIAL ONE FAMILY DWELLING | | H.I. HIGHWAY IMPROVEMENT |
| | G.O. GENERAL OFFICE | | R-75 RESIDENTIAL ONE FAMILY DWELLING | | S.C. SENIOR CITIZENS | | IND. INDUSTRY |
| | S.B. SPECIAL BUSINESS | | R-50I RESIDENTIAL ONE FAMILY DWELLING | | D.P.D. DOWNTOWN PRESERVATION DISTRICT | | R.I.D. RAILROAD IMPROVEMENT DISTRICT |

PREPARED BY:

SCHOOR & DePALMA, INC.
 Engineers and Design Professionals
 908/577-9000
 Justin Corporate Center
 200 State Highway Nine, P.O. Box 1149, Manalapan, NJ 07726

ROBERT W. BUCCO JR., N.J.P.E. LIC. NO. 38132
BOROUGH ENGINEER

